

1	2		3								4						5		6		7			8								
지시와 용접치수	지시와 모서리 부분		지시와 일반치수 허용공차 (KSB ISO 2768-1)								표면거칠기 (KSB 0161,0507,0617)						SYM'B	DATE	REASON OF CHANGE			DRAWN	CHECKED									
 $\alpha =$	지시와 일반 모서리 제거 $C = 0.3 \sim 0.8$ $R = 0.3 \sim 0.8$		결사 가공부	구분	0.5	6	30	120	400	1000	2000	$R_a$	✓	0.1/	0.2/	0.4/	0.8/	1.6/	3.2/	6.3/	12.5/	25/	1									
					~6	~30	~120	~400	~1000	~2000	~4000	Rmax		0.4S	0.8S	1.6S	3.2S	6.3S	12.5S	25S	50S	100S	2									
					중간급	±0.1	±0.2	±0.3	±0.5	±0.8	±1.2	±2.0	다듬질	~	▽▽▽▽	▽▽▽	▽▽	▽														

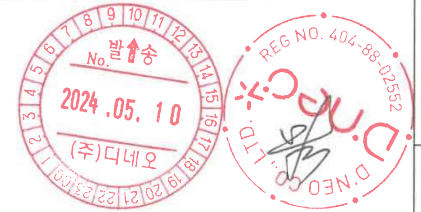
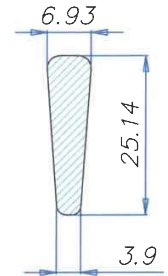
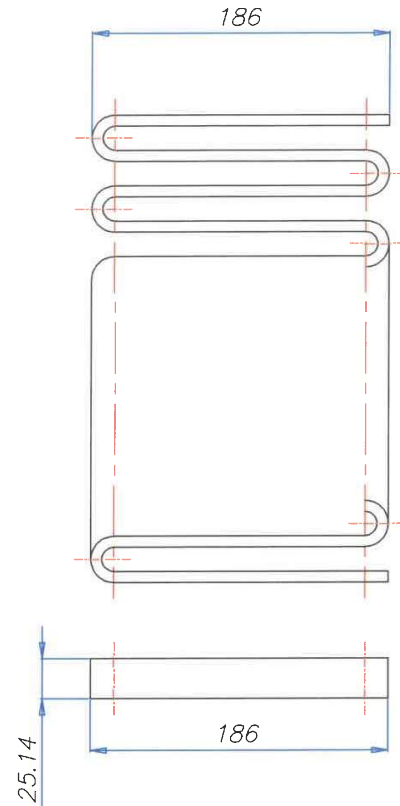
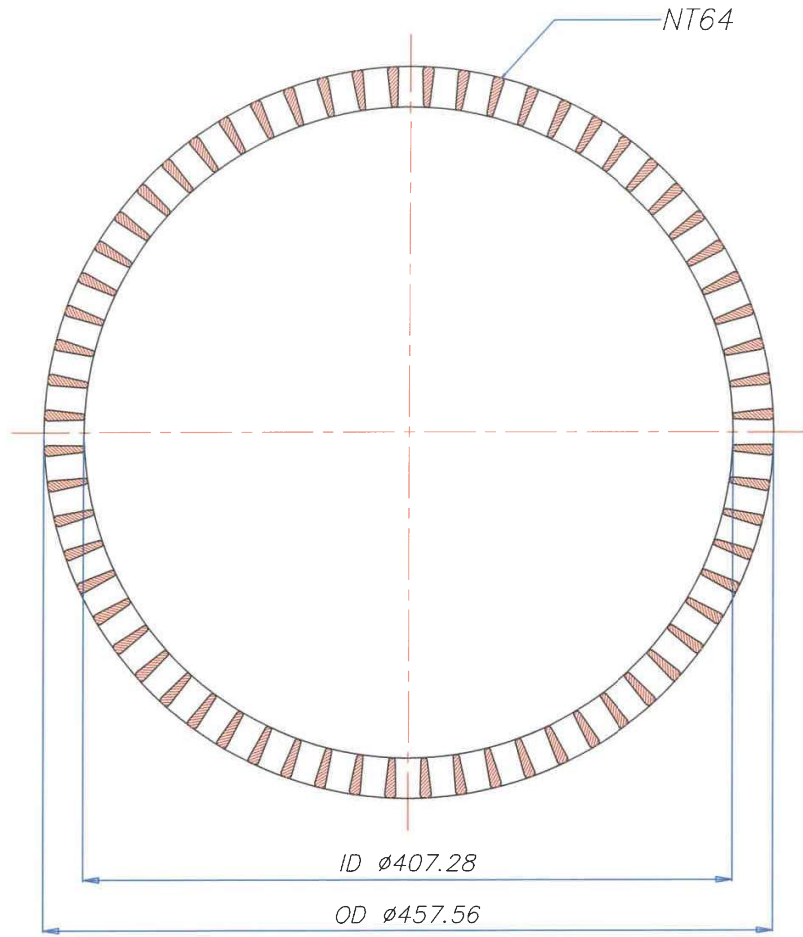

GIA HUNG PHAT (www.giahungphat.com.vn)

ORDER NO.		CUSTOMER.		
 <b>D'NEO CO.,LTD</b>		PROJECTION		
		DIMENSION	MM	
<b>Taper Grid Coupling</b> 1170T (GRID)		DATE.	SCALE	1:1
		2024.05.10	QUANTITY	1 SET
DWN.	DES.	CHK.	APP.	D'NEO DWG. NO.
			H.P	DNO-1170T-00-03

1	GRID	SAE9254HV	4	
NO.	DESCRIPTION	MATL	Q'TY	REMARKS

본 도면에 표기된 재질은 계명원 KS 강종기호(국가기술표준원 고시 제2016-0463호)로 대체하시오 계약시/제작시 참고 바랍니다.